

Job 1248796

Job No.
7010485-2021-1268

VARSITY + Bamwoa.

Scheduled

Priority 7
Due Date 24/01/2019 1 week, 5 days remained

[Edit](#)

Activity 95001 - Damage Recovery (P)

Comment 298 - replace damaged street light pole.

Schedule 2 - Element 30 - 230 Route Lighting State Network
Contract: CN-9842 - RMPC Electrical & ITS 18/19

Work Order WO2103014 - 298 - replace damaged light pole
10/01/2019 - 31/01/2019, Active

Claim -

Created 11/01/2019 /pjbamb1

Approved 11/01/2019 /pjbamb1

Job Type UNKNOWN

Source System AMMS

[Change Priority](#) [Change Activity](#) [Edit](#)

SIMS Info

SIMS Number 19SIT000218F

[Edit](#)

Received from SIMS Job has not been received from SIMS

[Unschedule from WO](#) [Enter Dissections](#) [Create Linked Job](#)

READY TO CLAIM
close 16-1-19.

Fault Details

[Edit](#)



STREET LIGHTING DAMAGES FORM

Fault ID No: 0218		Site ID No: 298		Date & Time of Damage: 9-1-19 0340	
Location of Damage: Bermuda st 300m Sth of Santa Maria St					
RoadTek Technician Onsite: A. Lynch					
Police Attended? Yes <input type="checkbox"/> No <input type="checkbox"/> Don't Know <input checked="" type="checkbox"/>			Name of Attending Officer:		
Badge No: _____ of _____				Police Station	
Description of Offending Vehicle:					
Registration No:					
Drivers Address:					
Pole No: W469697		Photo of footing: <input checked="" type="checkbox"/>		Photo of Scene: <input checked="" type="checkbox"/>	
FOOTING					
Footing Diameter:		350mm PCD <input checked="" type="checkbox"/>		500mm PCD <input type="checkbox"/> (>13m poles only)	
(PCD = opposite rag bolt (diagonal) distance)					
Is Footing (bolts in ground) usable? Yes <input checked="" type="checkbox"/> No <input type="checkbox"/>		Is Base Level? Yes <input checked="" type="checkbox"/> No <input type="checkbox"/>			
Is Slip Base usable? Yes <input checked="" type="checkbox"/> No <input type="checkbox"/>		Shim Washer & Bolts required? <input checked="" type="checkbox"/>			
Is Slip Plane at correct mounting height (refer to Standard Drawings 1380 to 1382): Yes <input checked="" type="checkbox"/> No <input type="checkbox"/>					
Grouting required? Yes <input type="checkbox"/> No <input checked="" type="checkbox"/>					
PIT		Asbestos Pit? NO		Pit Condition: Good	
POLE		Fixed <input type="checkbox"/>	Slip <input checked="" type="checkbox"/>	7.5 m <input type="checkbox"/>	8.5 m <input type="checkbox"/>
		10 m <input checked="" type="checkbox"/>	13 m <input type="checkbox"/>	Other Size: _____	
Does the pole have dynamic clearances from overhead reticulation (Refer RP&DM, Chapter 17)? Yes <input type="checkbox"/> No <input type="checkbox"/>					
OUTREACH					
1.5 metre		Single <input type="checkbox"/>	Double <input type="checkbox"/>	Extensions: 1m <input type="checkbox"/> 1.5m <input type="checkbox"/>	
3 metre		Single <input type="checkbox"/>	Double <input checked="" type="checkbox"/>	Extensions: 1m <input type="checkbox"/> 1.5m <input checked="" type="checkbox"/>	
Other:					
LUMINAIRE		Dome (SCO) <input type="checkbox"/>	Aero (FCO) <input checked="" type="checkbox"/>	GEC <input type="checkbox"/>	Sylvania <input type="checkbox"/>
		Goughlite <input type="checkbox"/>	LED <input type="checkbox"/>		
LAMP		Lamp Type: HPS <input checked="" type="checkbox"/> Mercury <input type="checkbox"/> MH <input type="checkbox"/>		LED T2 <input type="checkbox"/> LED T3 <input type="checkbox"/>	
Lamp Wattage: 150W <input type="checkbox"/>		198W: T2/T3 <input type="checkbox"/>	250W <input checked="" type="checkbox"/>	298W: T2/T3 <input type="checkbox"/>	300W <input type="checkbox"/>
		400W <input type="checkbox"/>	700W <input type="checkbox"/>		
CABLE: 15 m <input type="checkbox"/>		20 m <input checked="" type="checkbox"/>	25 m <input type="checkbox"/>	PE CELL <input type="checkbox"/> Shorting Plugs <input type="checkbox"/>	
Slip Base Re-Openable Joint <input type="checkbox"/>		Fixed Base Re-Openable Joint <input type="checkbox"/>		Pins & Clamps <input checked="" type="checkbox"/>	
3-Pin Outlet & Plug <input type="checkbox"/>		Underground power supply <input type="checkbox"/>		Overhead power supply <input type="checkbox"/>	
Is cable de-energised? Yes <input checked="" type="checkbox"/> No <input type="checkbox"/>					
FURTHER COMMENTS:					
Pole on site marked with paint, isolated power by removing fuse in bell joint.					
COMPLETION OF REPAIRS & TESTED:					
NAME OF SIGNAL MECHANIC:					
SIGNAL MECHANIC SIGNATURE:				DATE: ___/___/___	

WORK DETAILS & SIGNAGE SHEET

DOCKET NO
195431

Client Name: ROADTEK		Site Location: BERMUDA ST VARSITY LAKE		Date: 15.1.19	Signage Installed: 1930 hrs	Signage Removed: 2230 hrs	T/C Docket No: 206830		
Site Setup Details:	<input type="checkbox"/> Stop/Slow	<input type="checkbox"/> Shoulder Close	<input type="checkbox"/> Lateral Shift	<input type="checkbox"/> Full Road Closure	<input type="checkbox"/> Detour	<input type="checkbox"/> Part Road Closure / Local Access ONLY	<input type="checkbox"/> Footpath Closed	<input type="checkbox"/> Contra-flow	
Traffic Affected:	<input checked="" type="checkbox"/> North Bnd	<input checked="" type="checkbox"/> South Bnd	<input type="checkbox"/> East Bnd	<input type="checkbox"/> West Bnd	<input checked="" type="checkbox"/> LANE CLOSURE	<input type="checkbox"/> Left	<input checked="" type="checkbox"/> Right	<input type="checkbox"/> Middle	<input type="checkbox"/> Turning
Permit Authority Information:	<input checked="" type="checkbox"/> Dept of Transport/Main Roads		Permit No:		<input type="checkbox"/> Local Authority / Council:		Permit No:		
	<input type="checkbox"/> Blanket Permit / MOU (List Authority: eg BCC)		Permit No:		<input type="checkbox"/> Qld Police:		Permit No:		
Posted Road Speed: 80 km		Taper Length: 120 m		Work Area Length: 70 m		NOTES: Include info on scope of works & details of any changes to Signage / Devices during shift including times of changes:			

TGS Details (A copy of a "site specific TGS", or a site specific Mud Map with a "AATM or MUTCD generic TGS reference, or a site specific Mud Map with a copy of a "generic Client TGS" should be submitted with the AATM Risk Assessment completed for each setup)

1. Is there a site specific TGS?	Yes	Attach copy and note reference →	TGS Ref:	No
2. If no, can a AATM or MUTCD generic TGS be used unaltered?	Yes	Note reference → and complete mud map ↓	TGS Ref:	No
3. If no, is a Client generic TGS to be used unaltered?	<input checked="" type="checkbox"/> Yes	Attach copy, note reference → and complete mud map ↓	TGS Ref: N9137	No
4. If no, contact AATM Supervisor (a Traffic Management Design (TMD) qualified person is required), note actions: E.g. 0900 contacted AATM 'Supervisor' 0900, provided site details. 0930 TMD person signed off TGS and provided to TCs. 1000 Implement				

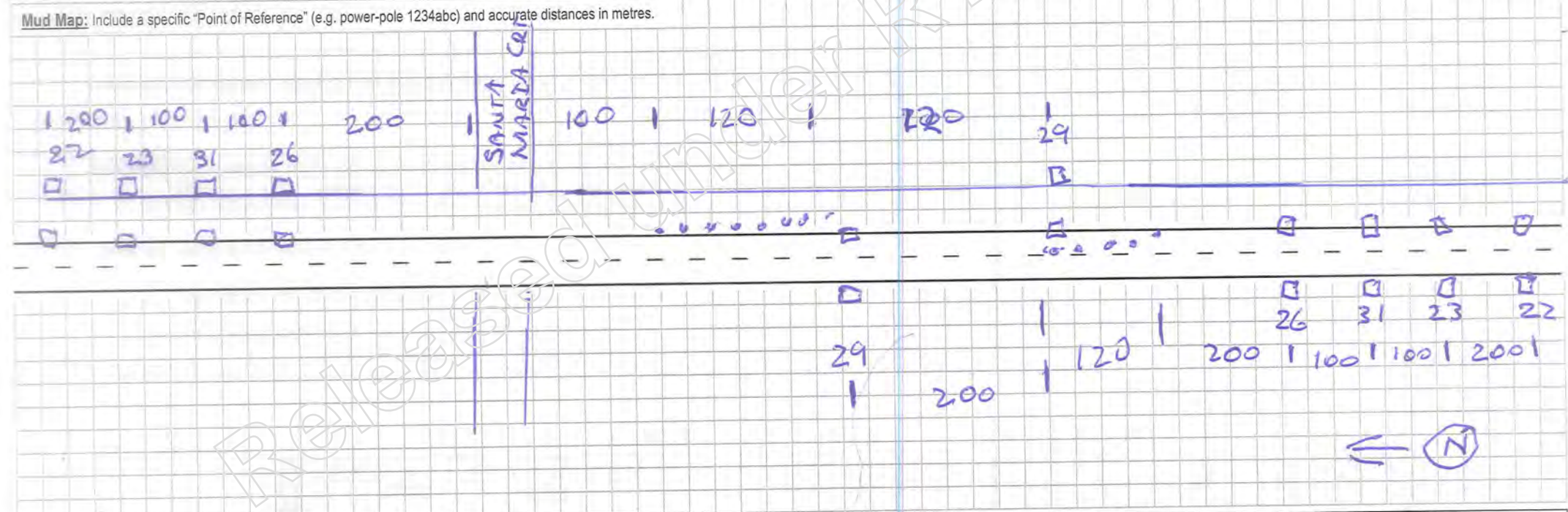

Traffic Controller Name (please print)	Traffic Controller Signature	Site Supervisor Name (please print)	Site Supervisor Signature
Not Relevant	Not Relevant	Not Relevant	Not Relevant
FORM 06-Work Details Signage Sheet - V3.doc		White Copy - Client	Green Copy - Office
		Blue Copy - Book	
		BMTMC Ph: 3292 6095	Contact Name
			Time hrs

RISK ASSESSMENT / JOB SITE ANALYSIS

DOCKET NO **195431**

Client Name:	Site Location:	Date	Start	Finish	T/C Docket No:
ROADTEK	BERMUDA ST VARSITY LAKES	15.1.19	1800 hrs	22:30 hrs	206830

SECTION "A": HAZARD IDENTIFICATION – (Complete the following to assist with identification of hazards at your work site)

ROAD CONDITIONS:	<input checked="" type="checkbox"/> Good	<input type="checkbox"/> Fair	<input type="checkbox"/> Poor	Number of Lanes in each Direction: 2	<input checked="" type="checkbox"/> Divided Road	<input type="checkbox"/> Undivided Road	
WEATHER CONDITIONS:	<input type="checkbox"/> Excessive Heat	<input type="checkbox"/> Sun glare	<input type="checkbox"/> Rain	<input type="checkbox"/> Storms	<input type="checkbox"/> High Wind	<input type="checkbox"/> Fog	<input checked="" type="checkbox"/> Night work
TRAFFIC VOLUME:	<input type="checkbox"/> Very High (consistent heavy flow)		<input checked="" type="checkbox"/> Medium (steady but not heavy)		<input type="checkbox"/> Low (occasional, intermittent flow)		
STREETScape: (Are there)	<input checked="" type="checkbox"/> Traffic Lights	<input type="checkbox"/> Roundabout	<input type="checkbox"/> Side streets		<input type="checkbox"/> Bends and/or hills – [on approach to work site]		
SURROUNDS: (Are there)	<input type="checkbox"/> Pedestrians	<input type="checkbox"/> Cyclists	<input type="checkbox"/> Shops, businesses, residents – [impacted by works]		<input type="checkbox"/> Bus Stops/Bus Routes – [impacted by works]		
NATURE OF WORKS:	<input type="checkbox"/> Excavation	<input type="checkbox"/> Electrical	<input type="checkbox"/> Asphalt	<input type="checkbox"/> Vegetation	<input type="checkbox"/> Road maintenance	<input checked="" type="checkbox"/> Other:	
WORK VEHICLES / HEAVY MACHINERY:	<input type="checkbox"/> Restricting visibility	<input checked="" type="checkbox"/> Hindering traffic flow	<input type="checkbox"/> Continually moving up and down job site				

Based on the above, summarise the main hazards associated with these works: _____

SECTION "B": CONTROL OF RISK - (Complete the following to illustrate how you have controlled risk)

NOTE: If you answer NO to any items in SECTION "B", works should not commence until discussion has addressed better control of risk and make notes in SECTION "C"

PRE-START:	YES	NO	N/A
Conduct tool box talk with client re: Scope of work, breaks etc	<input checked="" type="checkbox"/>	<input type="checkbox"/>	<input type="checkbox"/>
SET-UP:			
Must be based on either <input type="checkbox"/> MUTCD / <input checked="" type="checkbox"/> TGS / <input type="checkbox"/> AATM DIAGRAM	<input checked="" type="checkbox"/>	<input type="checkbox"/>	<input type="checkbox"/>
Will all signs be clearly visible to approaching traffic?	<input checked="" type="checkbox"/>	<input type="checkbox"/>	<input type="checkbox"/>
Will speed be reduced for safety of T/C's, workers and public?	<input checked="" type="checkbox"/>	<input type="checkbox"/>	<input type="checkbox"/>
Will ute/arrow board/warning lights be utilised for safety during set-up/breakdown?	<input checked="" type="checkbox"/>	<input type="checkbox"/>	<input type="checkbox"/>
Will tapers meet required length & be fully visible to approaching traffic?	<input checked="" type="checkbox"/>	<input type="checkbox"/>	<input type="checkbox"/>
Have conflicting (speed) signs been identified & covered up?	<input checked="" type="checkbox"/>	<input type="checkbox"/>	<input type="checkbox"/>
Will all streets affected by or leading into work area be properly signed?	<input checked="" type="checkbox"/>	<input type="checkbox"/>	<input type="checkbox"/>
Will lane widths be able to safely accommodate all types of traffic?	<input checked="" type="checkbox"/>	<input type="checkbox"/>	<input type="checkbox"/>

TRAFFIC CONTROL / PPE:	YES	NO	N/A
Do all T/C's have PPE including TC vest, headwear, safety glasses, steel caps?	<input checked="" type="checkbox"/>	<input type="checkbox"/>	<input type="checkbox"/>
Have T/C's discussed control points, escape routes, breaks / rotation of duties?	<input checked="" type="checkbox"/>	<input type="checkbox"/>	<input type="checkbox"/>
Do all T/C's have stop/slow bats & 2-way radios?	<input checked="" type="checkbox"/>	<input type="checkbox"/>	<input type="checkbox"/>
WORKSITE:			
Will set-up incorporate safe passage for pedestrians & cyclists?	<input type="checkbox"/>	<input type="checkbox"/>	<input checked="" type="checkbox"/>
Will T/C's maintain access to houses & businesses?	<input type="checkbox"/>	<input type="checkbox"/>	<input checked="" type="checkbox"/>
Will the worksite including all work vehicles be delineated with cones?	<input checked="" type="checkbox"/>	<input type="checkbox"/>	<input type="checkbox"/>
Is there a requirement for after-hours signage?	<input type="checkbox"/>	<input checked="" type="checkbox"/>	<input type="checkbox"/>
If "yes" have the after-hours signage requirements been discussed with the client?	<input type="checkbox"/>	<input type="checkbox"/>	<input type="checkbox"/>
Have all T/C's private vehicles been parked clear of worksite & control points?	<input type="checkbox"/>	<input type="checkbox"/>	<input checked="" type="checkbox"/>

SECTION "C": Summarise how you have controlled risk at the work site. Use this section to list any additional risks that arise during your shift and how you have controlled them

SECTION "D": WORK METHOD STATEMENT – It is a condition of employment that ALL Traffic Control Staff READ, UNDERSTAND and COMPLY with the AATM SWMS for the activity being performed.

Please Circle: **SWMS 1** **SWMS 2** SWMS 3 SWMS 4 SWMS 5
 I/We have adhered to the SWMS for setup & breakdown of signage & equipment at the site listed above YES / NO
 If NO, provide details of changes to SWMS procedure: _____

Traffic Controller Name (please print)		Traffic Controller Signature	
1. Not Relevant		Not Relevant	
2. Not Relevant		Not Relevant	
3.			
4.			

RoadTek

Conformance Report

GC - TRAF Sth Coast RMPC 18/19 CN9842 18-19

Project Number: 7610485/2021/1268

Lot: 298 VARSITY + BURMUDA

Work Type: REPAIR DAMAGED STREET LIGHT POLE

Description: GC - TRAF Sth Coast RMPC 18/19 CN9842

Other Details:

Raised By: Palmer Steve

Conformed By: P. BAMBUNG

Testing Level: Normal Reduced

Key Dates:

Opened: 10-1-19

Closed: 16-1-19

Work St: 15-1-19

Work End: 15-1-19

Guaranteed: P. Bambang Conformed: P. Bambang

Geometry: No geometry defined.

Notes:

This lot conforms in all respects with the standards and requirements specified in the contract documents, the lot verification records are complete and any non conformances have been actioned in accordance with the contract requirements

Signed:

Not
R
el
eyaru

Print Name:

P. BAMBUNG

Date:

16-1-19.

Released under RTI-DIAR

Equipment Fault 19SIT000218F

Event Metrics

Time Logged:	10/01/2019 3:38AM	Initiated by:	Luke Hansen [STMC]*
Start/Detected Time:	10/01/2019 3:38AM	Assigned To:	SCR Traffic Maintenance [SCR]@
Verified Time:		Assistance. Req.:	
Normal Flow:		Assistance. Arr.:	
End Time:	10/01/2019 4:05AM	Completed By:	Aaron Lynch [SCR][Roadtek]

Summary

Details: Street Light Down - Centre Median - Site 298

Region: South Coast

Asset Type: Street Light Category: Damage

Asset Name:

Asset Number:

Location

Location Type: Road

Road: BERMUDA STREET

Direction:

Suburb: ROBINA

Road Owner: Main Roads

Location Details: Centre Median near Dan Murpheys

Primary Camera:

Fault Details

Max. Response Time: 1 Week Paperwork Completed: Yes Attended: 10/01/2019

Status: Completed Priority: Low

Fault Car

Fault Car Referred: Yes Referred Time: 10/01/2019 3:38 AM A/H: Yes

Supervisor Referred: No Referred Time:

Repair Details

Technician Arrived: 10/01/2019 3:46 AM A/H Callout Ref:

System Conditions: Street light KD

Cause of fault: Vehicle Crash

Work Done: Arrived on site, assess site risk, found SL W469697 KD, took photos of scene, isolated power by removing fuse from bell joint, cleaned up debris, removed hardware from pole, marked pole with paint, installed cones around pole & on pole footing

Cost: \$0.00 Notified Officer:

Tech. Departure Time: 10/01/2019 4:05AM Normal Operation 10/01/2019 4:00AM

Resumed:

Technician: A.Lynch

Other parties present: W.Bailey

Further Work Suggested: Pole W469697 needs to be reinstalled

Referred to Other
 Contact:
 Ref: Time:
Further Works
 Further Works Order: No Completed Time:

Additional Info
 Blockage Type: Unknown Diversion Required: No
 Delay Expectation: Unknown Traffic Impact
 Lateral Position: Unknown Weather: Unknown
 Lanes Blocked
 1 2 3 4 5 6 Total:
 Opp. Link Affected: No
 Opp. Lanes Blocked:

Notifications

Time Occurred	Time Logged	Source/Destination	Direction	Contact	Contact Number
10/01/2019 3:37AM	10/01/2019 3:38AM	RoadTek	Incoming	Aaron RTEK	Not Relevant
Details: Street Light Down - Centre Median - Site 298					
Time Occurred	Time Logged	Source/Destination	Direction	Contact	Contact Number
10/01/2019 3:42AM	10/01/2019 3:42AM	RoadTek	Outgoing	RTEK Paging Service	
Details: ..Notified					
Time Occurred	Time Logged	Source/Destination	Direction	Contact	Contact Number
10/01/2019 3:46AM	10/01/2019 3:46AM	RoadTek	Incoming	Aaron RTeK	Not Relevant
Details: ..Arrived					

Linked Incident/Faults

Identifier	Type	Time Logged	Details
19SIT000231F	Fault	10/01/2019 1:26PM	Street Light Down - Centre Median - Site 298- reinstate

Released Under RTI - D TMR

Job 1248796

General

Priority: 7

Due Date: 28/01/2019 07:00

Planned Date:

Activity: 9001 - Damage Recovery (F)

Comments: 288 - replace damaged street light pole

Schedule: 2 - Element 00 - 230 Route Lighting State Resources

Contract: CH-3843 - DO NOT USE RAMP Electrical & ITS 18/19

Work Order: WO2103014 - 288 - replace damaged light pole 10/01/2019 - 31/01/2019

Claim: 7

Created: 11/01/2019 by atsamit

Approved: 11/01/2019 by atsamit

Completed: 28/01/2019 by sasanna

Job Type: UNKNOWHN

Source System: AMMS

SIMS Info

SIMS Number: 198100018P

Received From SIMS: job has not been received from SIMS

Create Linked Job | Draft

Fault Details

Fault Type: Damage

Fault Cause: damaged street light pole

Performed Work:

Work Description: 288 - replace damaged street light pole, outwash and luminaires.

Fault Cause: Replace damaged street light pole #1048897

Technician Comments: ready to claim job 18/01/2019.

Materials Used:

Technician Name: J. BAMBING, andrew

Finishing:

Refered Time: 10/01/2019 00:00

Technician Arrived: 10/01/2019 00:48

Work Started: 10/01/2019 00:48

Work Completed: 16/01/2019 02:00

Technician Departed: 16/01/2019 02:00

Service Restored: 16/01/2019 02:00

Time Compliance: 0 days, 0 hours, 0 minutes prior to due time



SAP Info

SAP Ref ID: 701528-2021-1368

SAP Network Loc: 7010489

Estim L-Details

Quantity	Amount	Estimated	Completed
		Not	
		R	
		e	
		l	
		t	



Site

Site ID: 000001

Name: SITE 288 - BERMUDA ST / SANTA MARIA CRT

Type: SWITCHBOARD

Status: In Service

Road: 108

Change: 13.16

Generation: -05.075289, 183.481982

Location Description: BERMUDA ST / SANTA MARIA CRT

Date Installed:

Special Instructions: INSPECTOR: MATT BAYLIS

Comments:

Attachments

No attachments

Add

Select File

Submit

Released under RTI - DTMR

WBS element	CO object name	Posting Date	Doc. Date	Quant	ValCOArCur	Name	Employee/app.name	Pers.No.	Cost Element	Partner object	DocumentNo	RefDocNo
51-004129.1.02	CL7 WO 1248796-298-0218F-10/...	14.01.2019	14.01.2019		Not Relevant	M10474/inv:19127/CLAMPS YELLOW (FOR PINS			91807	7010581 0020	4410380270	
51-004129.1.02	CL7 WO 1248796-298-0218F-10/...	14.01.2019				M10894/inv:19127/CONNECTOR SLIP BASE PIN			91807	7010581 0020	4410380270	
51-004129.1.02	CL7 WO 1248796-298-0218F-10/...	14.01.2019				M13544/inv:19127/PANEL/DINRAIL/ISOLATOR			91807	7010581 0020	4410380270	
51-004129.1.02	CL7 WO 1248796-298-0218F-10/...	14.01.2019				E2010/inv:19127/CABLE 4MM/2C TPS V90/5-V			91807	7010581 0020	4410380270	
51-004129.1.02	CL7 WO 1248796-298-0218F-10/...	14.01.2019				M2703/inv:19127/LUMINAIRE 250W AERO OPTI			91807	7010581 0020	4410380270	
51-004129.1.02	CL7 WO 1248796-298-0218F-10/...	14.01.2019				M481/inv:19127/LAMP 250W			91807	7010581 0020	4410380270	
51-004129.1.02	CL7 WO 1248796-298-0218F-10/...	14.01.2019				E7050/inv:19127/CABLE 2.5MM/2C TPS V90/5			91807	7010581 0020	4410380270	
51-004129.1.02	CL7 WO 1248796-298-0218F-10/...	14.01.2019						6004013	90010	1480/10300S	4410384552	1626527
51-004129.1.02	CL7 WO 1248796-298-0218F-10/...	16.01.2019	15.01.2019			31748 Truck S/Cab Tray Back 15t GVM Crane			90920	219/6T0005	4410387924	
51-004129.1.02	CL7 WO 1248796-298-0218F-10/...	16.01.2019				AATM #206830 2TC 2V			91805	7010583 8016	4410387925	
51-004129.1.02	CL7 WO 1248796-298-0218F-10/...	16.01.2019	16.01.2019					6005739	90010	1480/10300P	4410389346	1626527
51-004129.1.02	CL7 WO 1248796-298-0218F-10/...	16.01.2019						6016523	90010	1480/10300P	4410389348	1626527
51-004129.1.02	CL7 WO 1248796-298-0218F-10/...	16.01.2019						6017305	90010	1480/10200P	4410389350	1626527
51-004129.1.02	CL7 WO 1248796-298-0218F-10/...	17.01.2019	17.01.2019			M10850/inv:19169/BOLT ASSY SLIP BASE & W			91807	7010581 0020	4410389880	
51-004129.1.02	CL7 WO 1248796-298-0218F-10/...	17.01.2019				M3439/inv:19169/OUTREACH 3M DOUBLE			91807	7010581 0020	4410389880	
51-004129.1.02	CL7 WO 1248796-298-0218F-10/...	17.01.2019				M2699/inv:19169/OUTREACH EXTENSION 1.5M			91807	7010581 0020	4410389880	
51-004129.1.02	CL7 WO 1248796-298-0218F-10/...	17.01.2019				M1396/inv:19169/POLE 10M SLIP BASE			91807	7010581 0020	4410389880	

Released under RTI



Released under RTI - DTMR



MR 3 M

W
4
6
9
6
9
7

Released under RTI - DTMR





